

Modular Precision Air Conditioner ATP Rack Mount



ATP-Air cooled, rack mount

Air cooled, rack mount, split type, suitable for micro data center, mini modular data center solutions.

Capacity: 3.9kW-12.0kW

Copper piping adopts quick connection and supports bottom and top connections

Slide drawer style electric box makes service easier

R410A green refrigerant is highly efficient and no

Inverter compressor and EC fan works at high efficiency, maintains temperature within envelop and prevent compressor from cycling during low heat load period

Front air outlet suitable for installation

Standard rack mount structure fully compatible with server rack is flexible for future expansion

Precision cooling controller monitors and protects unit constantly. Easy to be integrated into BMS to display, control and manage the system

Compressor locating in outdoor unit lowers the noise level then better suits customer expectation of mini data center application

Cold air supply and hot air return inside the cabinet.

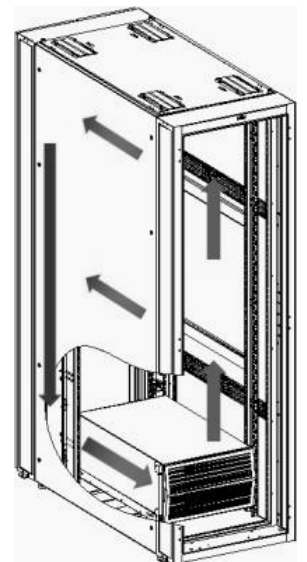

ATP Air cooled, rack mount Technical Data

Model	ATP-S-003KA	ATP-S-005KA	ATP-S-007KA	ATP-S-012KA
Total Capacity-kW	3.9	5.9	8.6	12.8
SHR -%	100	100	100	100
Air Volume -m3/h	700	1100	1200	2400
Mount Type	Rack	Rack	Rack	Rack
Height -mm	266(6U)	355(8U)	445(10U)	533(12U)
Depth -mm	828	828	828	828
Width -mm	483	483	483	483
Weight -kg	31	43	52	70
Reheat(optional) -kW	1.2	1.2	2.4	2.4
Hum.(optional) -kg/h	-	-	-	-
Power Input ¹⁾	208-240V/50-60Hz/1Ph-2Ph	208-240V/50-60Hz/1Ph-2Ph	208-240V/50-60Hz/1Ph-2Ph	380-415V/50-60Hz/3Ph
FLA -A ¹⁾	13.9	15.2	21.6	18
Power Input ²⁾	-	-	-	208V/60Hz/3Ph
FLA -A ²⁾	-	-	-	32.9
Outdoor Unit	ATP-KSF06AC	ATP-KSF08AC	ATP-KSF12AC	ATP-KSF18AC
Height -mm	632	790	790	1240
Depth -mm	395	420	420	420
Width -mm	800	800	800	800
Leg Height -mm	-	-	-	-
Weight -kg	35	38	50	77
Power Input ¹⁾	208-240V/50-60Hz/1Ph-2Ph	208-240V/50-60Hz/1Ph-2Ph	208-240V/50-60Hz/1Ph-2Ph	380-415V/50-60Hz/3Ph
FLA -A ¹⁾	12.6	13.2	19.6	16
Power Input ²⁾	-	-	-	208V/50-60Hz/3Ph
FLA -A ²⁾	-	-	-	29.3

Notes:

- 1, Air flow is based upon maximum setting. Fan modulates per real loads.
- 2, Cooling capacity based on 37°C/24%RH return air and 35°C outdoor temperature with the standard condenser. 3, FLA of indoor unit includes FLA of outdoor unit, and outdoor unit power connected from indoor unit.
- 4, Standard unit works -15°C and above outdoor temperature. Select low temperature kit to work -35°C and above outdoor temperature

ATP Air cooled package

Air cooled package type cooling unit, mounted at bottom or rack.
No complex installation.

Capacity: 3.5kW
Height: 8U



- Industry top brand compressor. Highly reliable and efficient.
- Precision cooling controller monitors and protects unit constantly. Easy to be integrated into BMS to display, control and manage the system.
- Compatible with standard rack size forms unified and integrated micro data center solution.
- Packaged design easy for installation, service and shipping.
- Rack mount means good air management of hot/cold stream and no concern of water leak.

Air flow inside the cabinet

Cold air supply and hot air return inside the cabinet.



ATP Air cooled package Technical Data

Model	ATP-S-003HAN
Total Capacity - kW	3.5
SHR -%	100
Airflow -m3/h	700
Reheat -kW	1.2
Humidification -kg/h	N/A
Mount Type	Rack Bottom
Power Input	220V/50Hz/60Hz/1Ph
Height -mm	355 (8U)
Depth -mm	900
Width -mm	440
Weight -kg	45
Cooling Type	Air Cooled DX
Refrigerant	R410A
FLA -A	13.5
Monitoring Port	RS485
Working Range-°C	-15-45

Notes:

1. Cooling capacity based on 37°C/24%RH return air and 35°C outdoor air.
2. Options including SNMP monitoring protocol.

ATP-Top Mount Packaged DX

Air cooled, top mount, indoor and outdoor packaged, suitable for micro data center, mini modular data center solutions.

Capacity: 2.5kW - 5.5kW

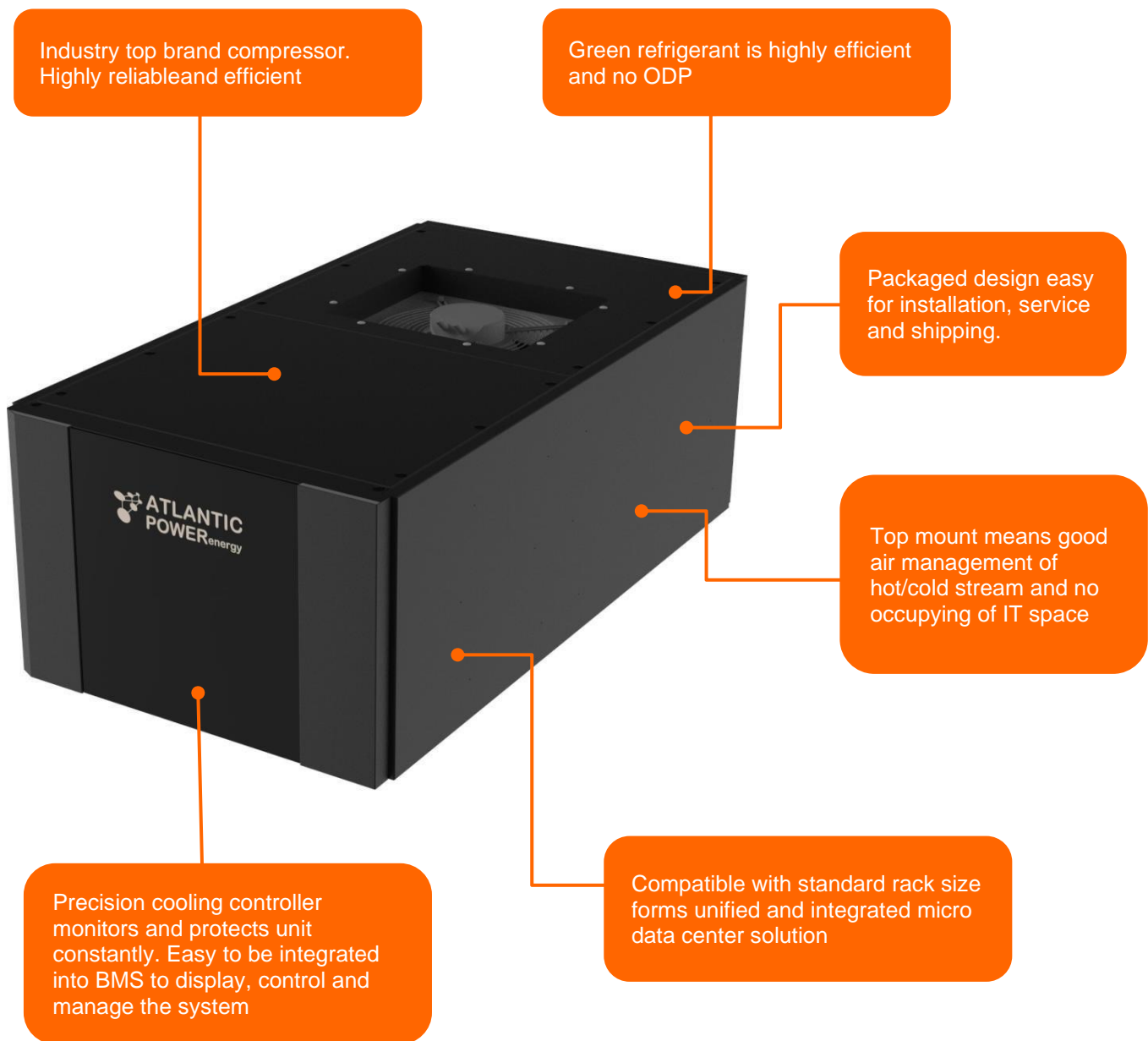

Air flow inside the cabinet

Cold air supply and hot air return inside the cabinet

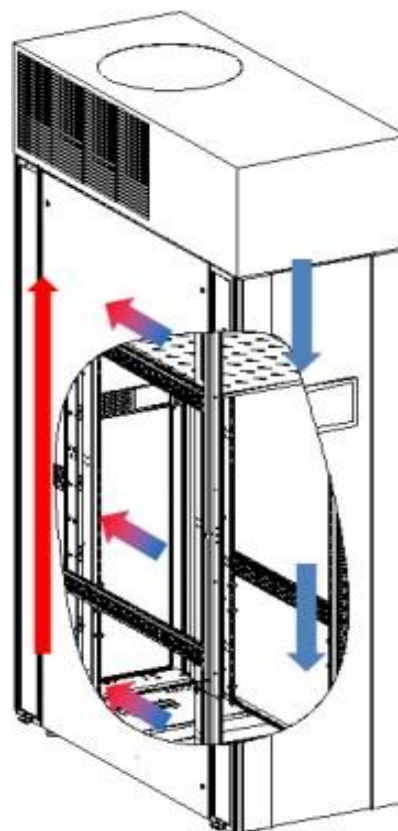

ATP-Top Mount Packaged DX Technical Data

Model	ATP-S-002TA	ATP-S-003TA	ATP-S-005TA
Total Cooling-kW	2.5	3.5	5.5
SHR-%	100	100	100
Air Volume-m ³ /h	500	600	1200
Mount Type	Top	Top	Top
Cooling Type	DX	DX	DX
Height-mm	390(9U)	390(9U)	521(12U)
Depth-mm	1100	1100	1100
Width-mm	600	600	600
Weight-kg	50	55	65
Power Input	208-240V/50Hz-60Hz/1Ph-2Ph	208-240V/50Hz-60Hz/1Ph-2Ph	208-240V/50Hz-60Hz/1Ph-2Ph
FLA-A	5.5	6.5	7.8

Notes:

1. Cooling capacity based on 37°C/24%RH return air and 35°C outdoor air.
2. Options including SNMP monitoring protocol, condensate evaporation kit.

